

STUDIO RENTAL RATES [DESCRIPTION / SIZE]	OFF PEAK RATE • MON TO FRI 2 to 6 pm	PEAK RATE • MON TO FRI 6 to 11 pm • SAT 9 am to 6 pm • SUN 10 am to 7 pm
Studio 1 [Glass] 990 sqft (Triangle-ish) 12.6m x 13.3m x 9m x 4m	\$ 70.00	\$ 80.00
Studio 2 [Ballet] 1,050 sqft (Rectangle) 13.3m x 7.8m Dance Mat, Ballet Barres	\$ 90.00	\$ 100.00
Studio 3 [Party] 1,300 sqft (Rectangle) 15m x 8m DJ sound system setup Mood lighting setup	\$ 90.00	\$ 100.00
Studio 4 [Jazz] 1,250 sqft (Rectangle) 15m x 7m	\$ 50.00	\$ 60.00
Studio 5 [Tap] 670 sqft (Square-ish) 9m x 7m	\$ 40.00	\$ 50.00
Studio 6 [Private] 250 sqft (Rectangle) 6m x 4m	\$ 30.00	\$ 40.00

1. All rates are quoted on a per hour basis.
2. Rates are applicable to usage of studios for rehearsals only.
3. Rates are not applicable to usage of studios for conducting classes.
4. For studio rental rates to conduct classes, please contact Fen Tonge at fen@swingapore.com.

Last updated: **13 Apr 2010**

JITTERBUGS SWINGAPORE

2 Handy Road
#B1-08 The Cathay
Singapore 229233
T.65.6887.0383 | F.65.6887.0538
dance@swingapore.com
www.swingapore.com



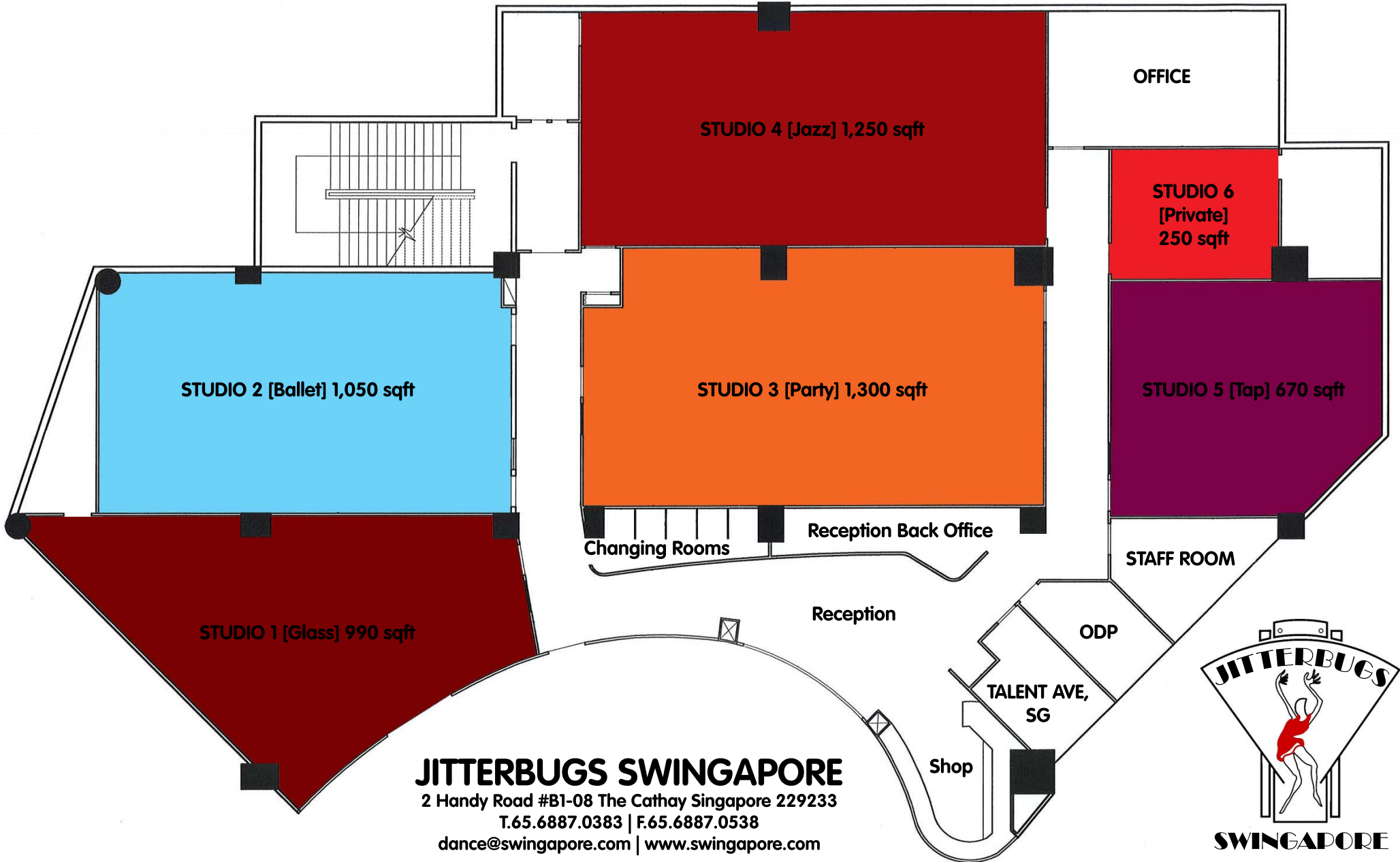

JITTERBUGS SWINGAPORE
 2 Handy Road #B1-08 The Cathay Singapore 229233
 T.65.6887.0383 | F.65.6887.0538
 dance@swingapore.com | www.swingapore.com

